



Ariennir gan
Lywodraeth Cymru
Funded by
Welsh Government

Celebrate Safely

South Wales
Fire and Rescue Service



Gwasanaeth Tân ac Achub
De Cymru



Gwasanaeth Tân ac Achub
Canolbarth a Gorllewin Cymru
Mid and West Wales
Fire and Rescue Service



Gwasanaeth Tân ac Achub
Fire and Rescue Service

Working together for a safer Wales

Fireworks

The Welsh Fire and Rescue Services recommend you attend an organised display.

Don't:

- Don't go back to a lit firework – even if it hasn't gone off it could still explode.
- Don't throw fireworks or put them in your pocket.
- Don't drink alcohol if you are setting off fireworks.
- Don't use paraffin or petrol on a bonfire.

Do:

- Keep a bucket of water nearby.
- Store fireworks in a closed box and take them out one at a time.
- Follow the instructions on each firework. Use a torch to read them not a naked flame.
- Light fireworks at arm's length, using a taper.
- Make sure everyone stands well back.
- Always supervise children around fireworks and never give sparklers to children under five.
- Light sparklers one at a time and wear gloves.
- Keep pets indoors.
- Only buy fireworks marked BS7114.

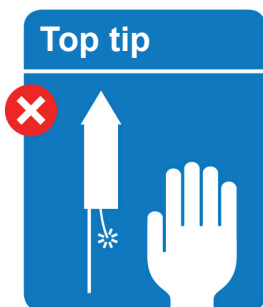

**Never go back
to a lit firework**

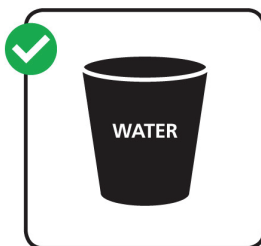

Celebrations

Don't

- Don't place candles near a Christmas tree or materials that can catch light easily.
- Don't attach decorations to lights or heaters as they can burn easily.
- Don't leave cooking unattended.
- Don't let Christmas tree light bulbs touch anything that can burn easily, such as paper or fabrics.

Do:

- Check your Christmas lights carry the British Standard sign and replace any bulbs that blow.
- Make sure that any visitors and additional family members know how to escape in an emergency.
- Always switch Christmas lights off and unplug them before leaving the house or going to bed.
- Test the batteries in your smoke alarm every week. Never remove them.
- Keep candles away from children. Make sure that they are extinguished properly when you leave the room.
- Take time to check on elderly relatives and neighbours at times of celebration as they are at greater risk from fire.



**Unplug
fairy lights**

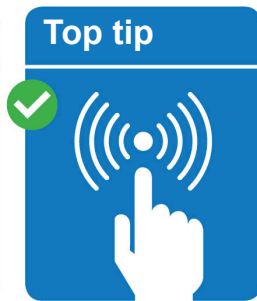

Test it

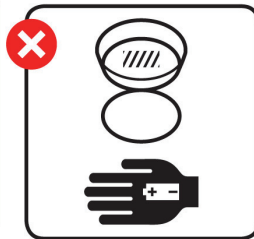

Sky (Chinese) lanterns

We do not recommend the use of Sky lanterns. They are a fire risk to property, crops, vehicles and livestock and can harm the environment. However, if you do intend to use a lantern please consider the following advice.

Don't:

- Don't use a damaged lantern.
- Don't release lanterns in urban areas.
- Don't release lanterns in areas containing animals or growing crops.
- Don't launch a lantern near a road or public highway, especially major roads and motorways.

- Don't launch a lantern if the wind is stronger than a light breeze.

Do:

- Make sure the launch area is kept clear of flammable materials.
- Launch lanterns away from obstacles such as trees, electricity and telephone power lines or buildings.
- Check wind direction and speed before launch.

For more safety leaflets please visit:

www.freesmokealarm.co.uk



Never launch lanterns near trees or power lines

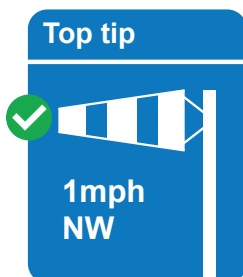

Check wind direction and speed before launch